

| BILL OF MATERIALS | | | | |
|-------------------|------|-------------|----------|---------|
| DET. | QTY. | DESCRIPTION | MATERIAL | PLATING |
| 1 | 1 | BODY | BRASS | NICKEL |
| 2 | 1 | NUT | BRASS | NICKEL |
| 3 | 1 | LUG | BRASS | TIN |

| REVISIONS | | | |
|-----------|-------------|------------|-------------|
| SYM | DESCRIPTION | REVISED BY | DATE / APPR |
| | | | |

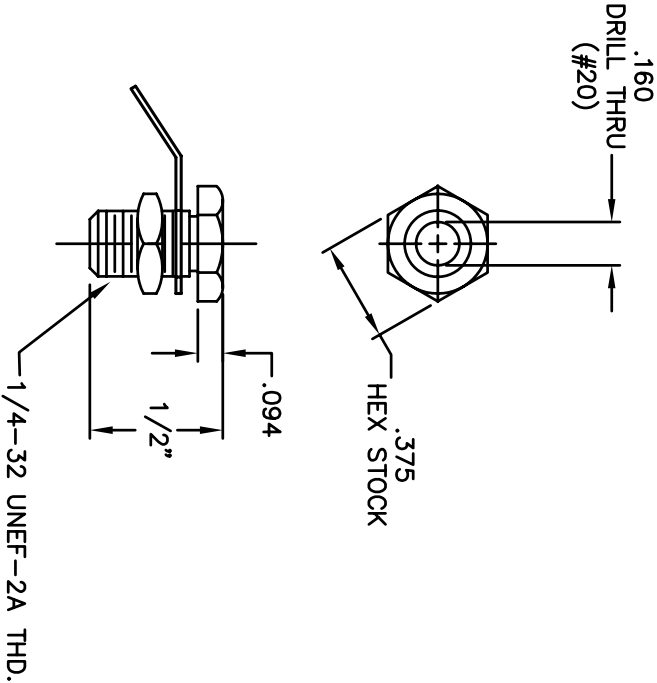

NOTE:
1.) RECOMMENDED TORQUE LIMIT
24 INCH LB

| | | | |
|--|--------|--|------------------------|
| MATERIAL: SEE TABLE | | FINISH: SEE TABLE | |
| DIMENSIONAL TOLERANCES UNLESS OTHERWISE SPECIFIED | | TITLE: 101 BANANA JACK ASSEMBLY | |
| .XX | .XXX | .XXX | |
| --- | --- | --- | |
| FRACTIONS | ANGLES | SCALE | |
| --- | --- | 2X | |
| HEAT TREAT: | --- | DRAWN: C.MCBRIDE | DATE: 08-02-00 |
| CHECKED: | --- | DATE: | |
| APPROVED: | --- | DATE: | |
| PLOT SCALE: | 1=1 | SIZE: B | DRAWING NUMBER: SD-101 |
| | | ISSUE: C | |

ABBATRON
Electronic Connectors and Hardware
632 Arch Street, Meadville, Pa. 16335